

IP Outdoor User Manual

## INSTRUCTION

IP Video Door Phone system is a full-featured IP based door entry system that allows you to monitor and interact with visitors at your door, from anywhere your mobile device has a WiFi or data connection.

Please read these instructions carefully and follow all of the required steps during setup to ensure your enjoyment of a fully functional system. You may connect the IP Outdoor to your LAN (Local Area Network) either through a Wireless (WiFi) connection or a Wired (Ethernet Cable) connection. As connecting with any video and audio streaming device, wired connections are preferred over WiFi. But you can also install and connect devices with WiFi if it's much more stable and smooth in your environment.



### Note:

- 1.The System only works with 2.4GHz WiFi,  $\geq 2\text{Mbps}$  (upload / download speed) are suggested.
- 2.The System is incompatible with 5GHz WiFi.

# CONTENTS

<b>1.0 Package Contents</b>	<b>1</b>
<b>2.0 IP Outdoor</b>	<b>2</b>
2.1 Product View	2
2.2 Specification	2
2.3 Wiring Diagram	3
<b>3.0 APP Configuration Preparation</b>	<b>6</b>
3.1 Preparation of smart devices & network	6
3.2 Preparation of the IP Outdoor	6
3.3 Download APP and register an account	7
3.4 Set the needed authorizations	9
<b>4.0 DoorDeer APP</b>	<b>10</b>
4.1 IP Outdoor Configuration by WiFi	10
4.2 APP Account Settings	14
4.3 Notification Settings	16
4.4 Monitoring	17
4.5 IP Device Settings	18
4.5.1 Master-account in Android System	18
4.5.2 Master-account in iOS System	19
4.5.3 Sub-account in Android System	20
4.5.4 Sub-account in iOS System	21
4.6 APP icon description	22
<b>5.0 Installation</b>	<b>23</b>
5.1 Installation Diagram	23
5.2 Instruction	23
5.3 Notes in installation process	24
<b>6.0 Main Function</b>	<b>26</b>
6.1 Intercom & Monitor & Unlock the door	26
6.2 Check history events and play back	26
6.3 Motion Detection Settings	27
<b>7.0 Q&amp;A</b>	<b>31</b>



## PACKAGE CONTENTS

- (1) IP Outdoor
- (1) Accessories bag (Varistor, Plastic wall plug, Screws with Anchors, Hex-Head Screws, Allen Key, etc.)
- (1) Metal Rain Cover or Back Box
- (1) External WiFi Antenna
- (1) 12VDC Power Supply

## 2. IP Outdoor

### 2. 1 Product View

Without keypad version

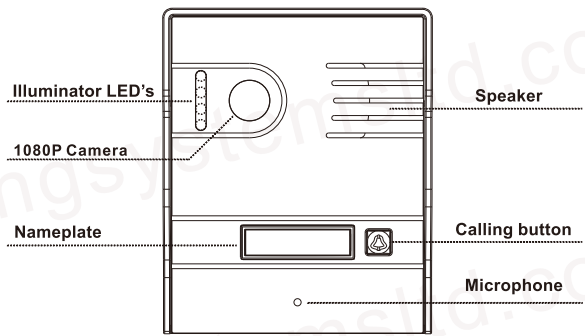

### 2. 2 Specification

Material	Aluminum alloy
Camera	1080P
View angle	110°
Working voltage/current	DC 12V, 1000mA
Working temp.	-25℃~65℃
Illumination	0.1 Lux
Dust/water proof rating	IP65 (With Rain Cover)
Installation	Surface mounted
Dimention	112(W)*136(H)*52(D)(mm)
Connectivity	WiFi + Ethernet Connection (PoE for option)
Transmission Frequency	2.4GHz
Motion Detection	Supported
History events playback	APP(iOS & Android) + IP Monitor

## 2. IP Outdoor

### 2. 3 Wiring diagram

### Connection of BELL / POWER

#### Wiring Diagram for Power Supply Connections and Connection to Existing Door Chime (Optional)

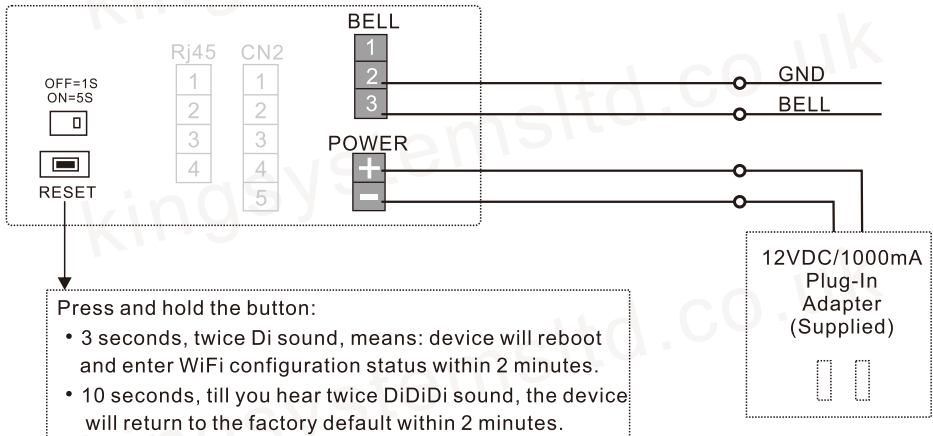

**Lock and bell relays are rated maximum 4 Amps, 30VDC**

## 2. IP Outdoor

### Connection of CN2

#### Wiring Diagram for Normally Open Circuit (e.g. Electronic Door Strike or Deadbolt)

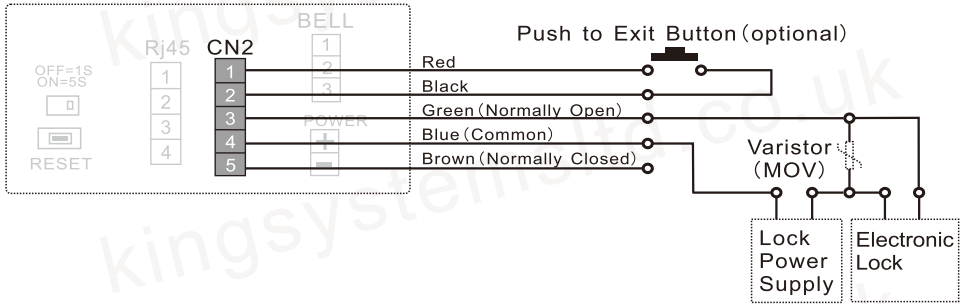

Lock and bell relays are rated maximum 4 Amps, 30VDC

### Connection of RJ45

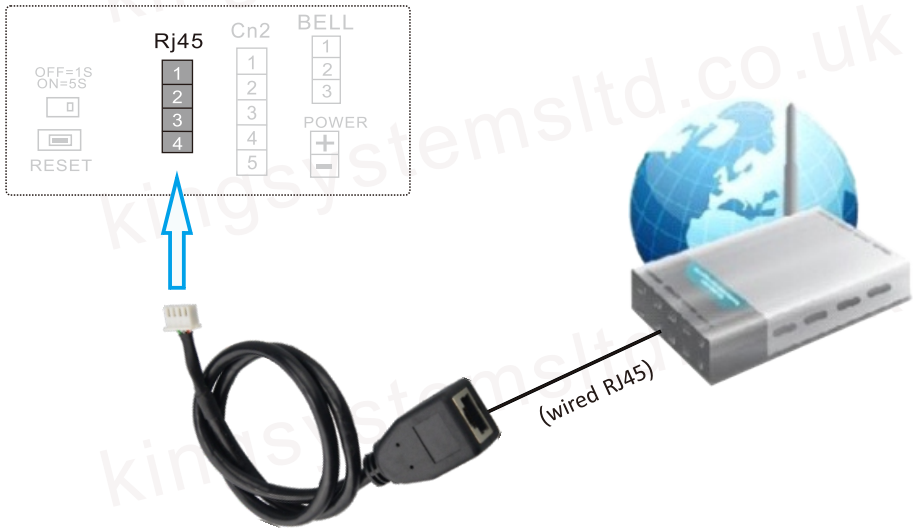

Wiring Diagram for Normally Closed Circuit  
(e.g. Electromagnetic Lock)

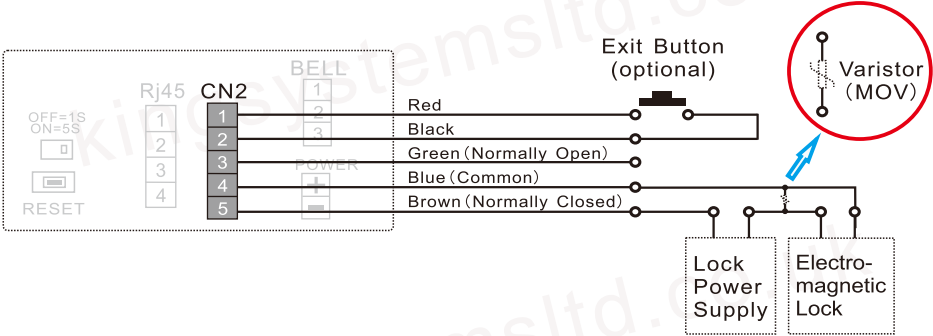

Lock and bell relays are rated maximum 4 Amps, 30VDC



## 3. App Configuration Preparation

---

### 3.1 Preparation of smartphones / tablets and network

- Make sure your device is operating with sufficient internet bandwidth, 2Mbps (upload / download speed) are suggested.
- For best performance, the smart device(s) need to be on WiFi / 4G mobile network. Actual performance depends on the working internet environment.
- If you have limited internet bandwidth, try to avoid more than two users(including App users) operating / viewing to IP Outdoor / IP Camera simultaneously for best performance.
- For the 1st time configuration, please make sure the smart devices / IP Outdoor are all under the same WiFi Network.
- Turn off the Cellular data or any running VPN services on your smart devices.
- Enable the Location (GPS) services of your phone.

### 3.2 Preparation of the IP Outdoor

**Note:** Read all below tips first before you do any operation.

- **Supply power on IP Outdoor** with the adapter(12V,1A), a BiBi sound will be heard, the boot up process(1~2 minutes) begins, the IP Outdoor's LEDs flash 3 times, when you hear a 'wuan' sound, the boot up process is completed.
- **Connect IP Outdoor to your router** with ethernet cable(suggested) **or connect Antenna** (come with KIT) with IP Outdoor.
- **Performing factory default reset** by pressing and holding 'RESET' button on the back of the device for 10 seconds, until you hear twice DiDiDi sound (NOT Di sound), then release the button. Wait for the boot up process of the device for 1~2 minutes. IP Outdoor's LEDs flash 3 times, a 'wuan' sound will be heard after boot up process / default setting completed, then, you can begin your configuration.

**Note:** Please make sure that the boot up process of the device is completed before you do any operation on APP or device, otherwise, it cannot work properly.

## 3. App Configuration Preparation

---

### 3.3 Download APP and register an account

- **Download the App**

1. Before configuration, please download the 'DoorDeer' App.  
Free downloads are available on the Google Play Store (Android) and the Apple App Store (iOS)



2. Complete the installation of the App on your smart phone / tablet.
  - The DoorDeer App is free to download and use.
  - Please keep the DoorDeer App updated to the latest version.
  - The App is subject to change without notice.

### 3. App Configuration Preparation

---

- **Setup and Log in with a New User Account**

1. Double check your smart phone is connected to the local WiFi network, which you want your IP Outdoor to be connected.
2. Open the DoorDeer App.
3. Click the 'Sign up' button.
4. Choose the nearby server region.
5. Enter your email address as your account.
6. Create a new password.
7. Confirm your new password.
8. Read and click the terms and conditions to agree.
9. Press the 'Sign up' button and a pop-up message will appear, click 'ok'.
10. You'll be redirected to Login screen, please log in with your new account and password.

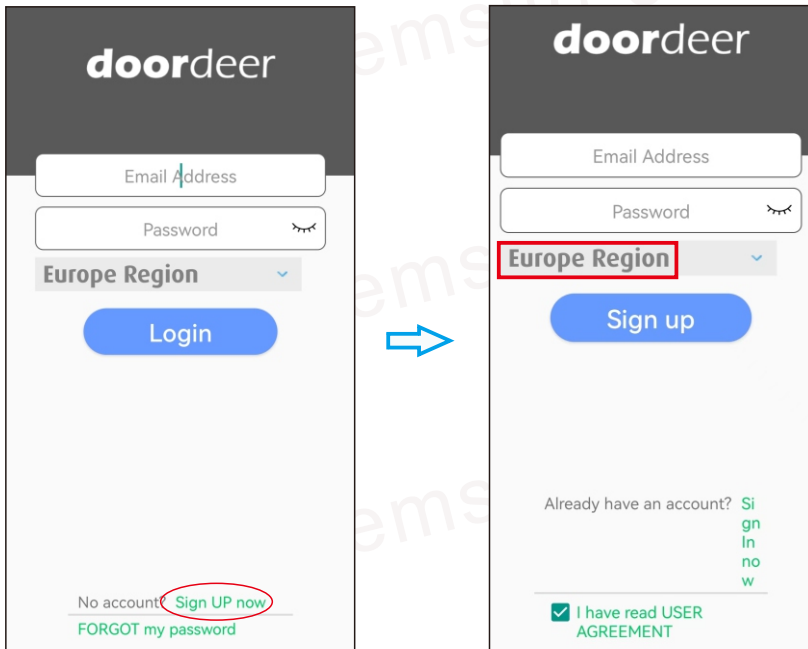

### 3. App Configuration Preparation

---

#### 3.4 Before configuration please set the authorizations needed:

- Notifications --- switch on 'Allow notifications'
- Location --- switch on 'Allow only while in use'
- Camera / Microphone --- switch on 'Allow only while in use'

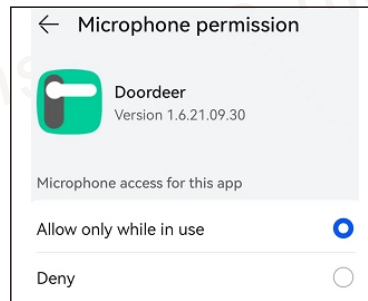
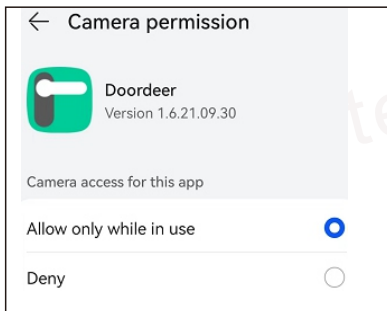
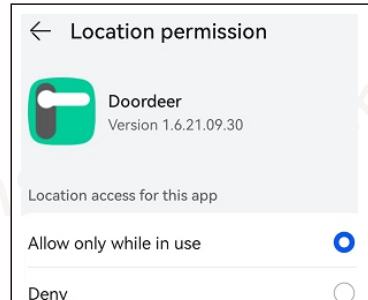
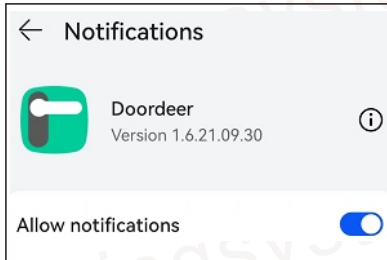

## 4. DoorDeer App

### 4.1 IP Outdoor Configuration (by WiFi)

- Click  on the left Column, Click  Add device to add your IP Outdoor. If this is the first device you add on DoorDeer App, you also can tag 'doorbell' icon to add as step 1

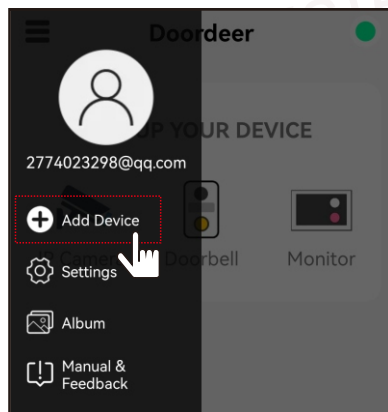

or

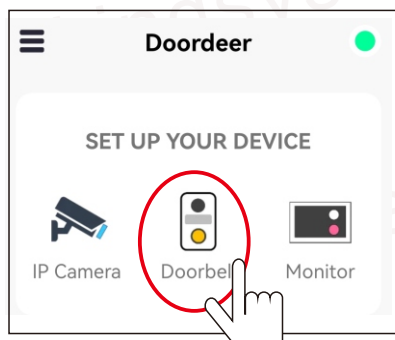

Step 1

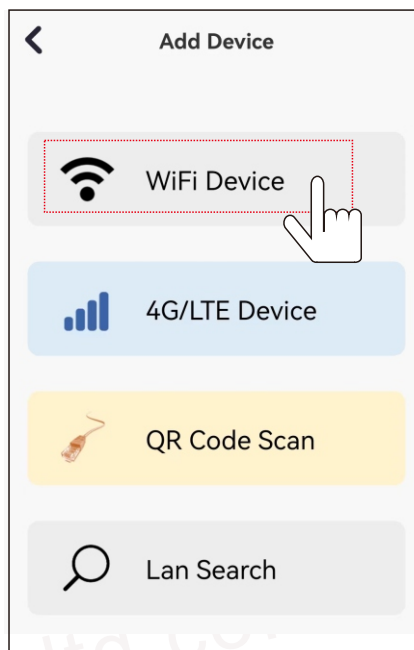

Step 2

## 4. DoorDeer App

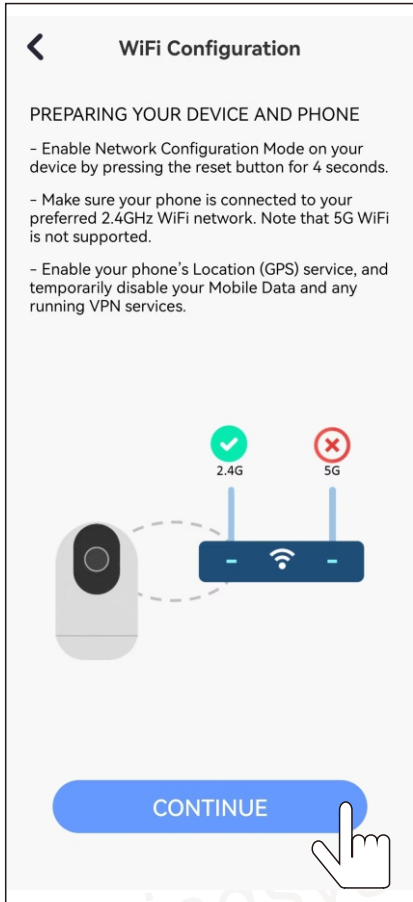

Step 3

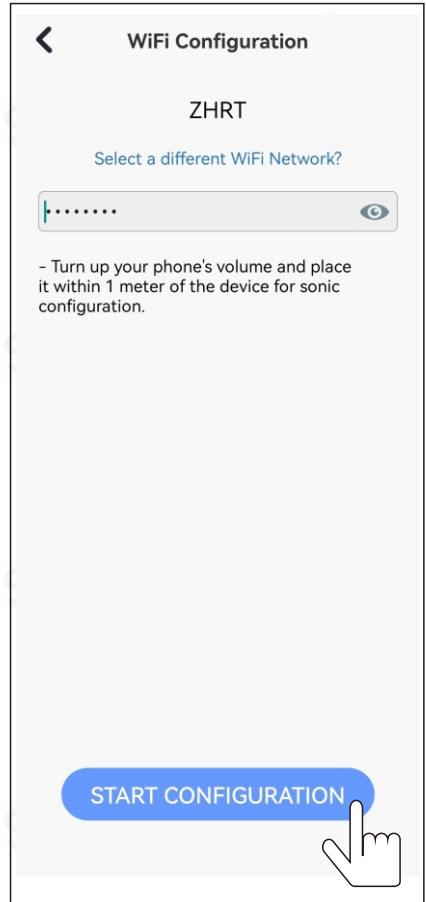

Step 4

Connect the IP Outdoor to local WiFi account

**Note:** In the iOS system, please connect the local WiFi separately.

## 4. DoorDeer App

---

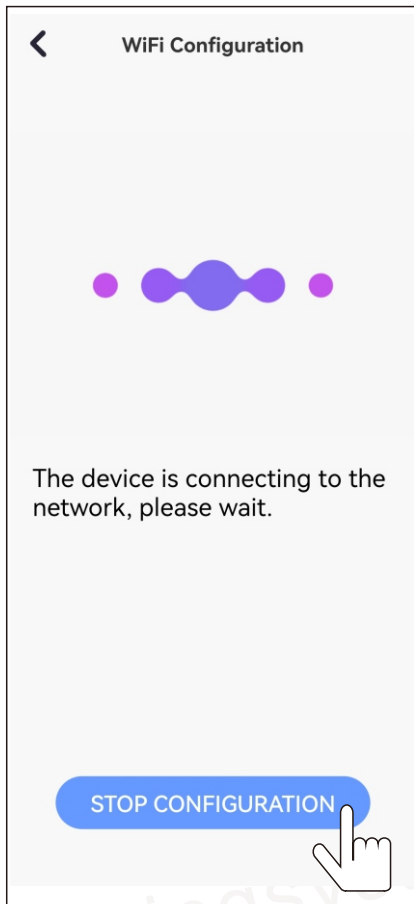

Step 5

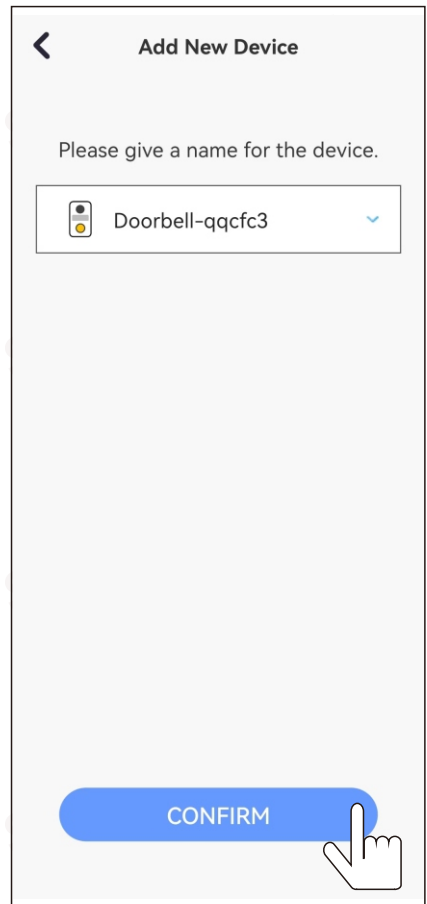

Step 6

Rename it and click 'CONFIRM'

### Note:

After click 'START CONFIGURATION', you will hear the wave sound, please set phone's volume to max. and put its speaker closer to the microphone of the IP Outdoor.

## 4. DoorDeer App

---

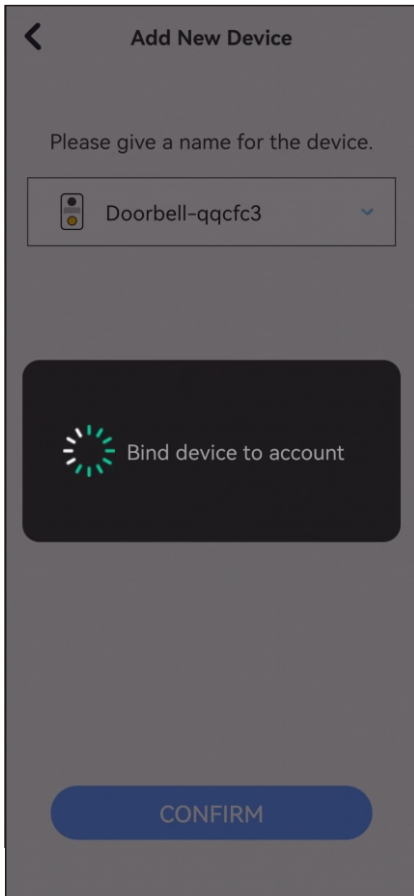

Step 7

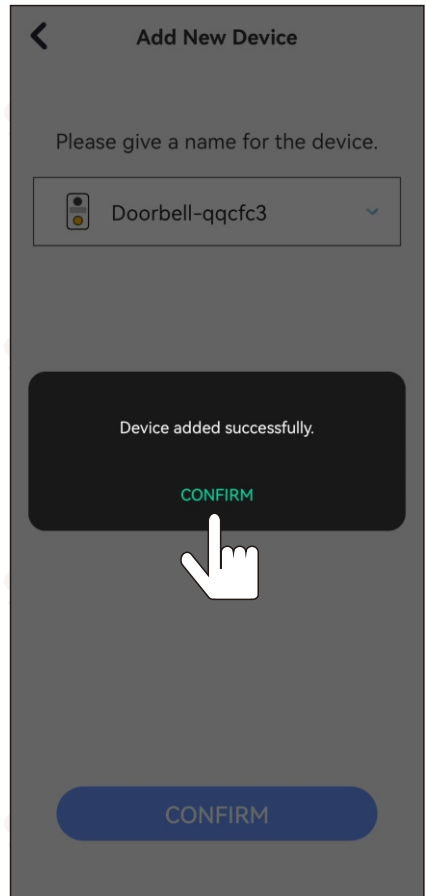

Step 8

Click 'CONFIRM' to complete the configuration



## 4. DoorDeer App

### 4.2 APP Account Settings

Android Version

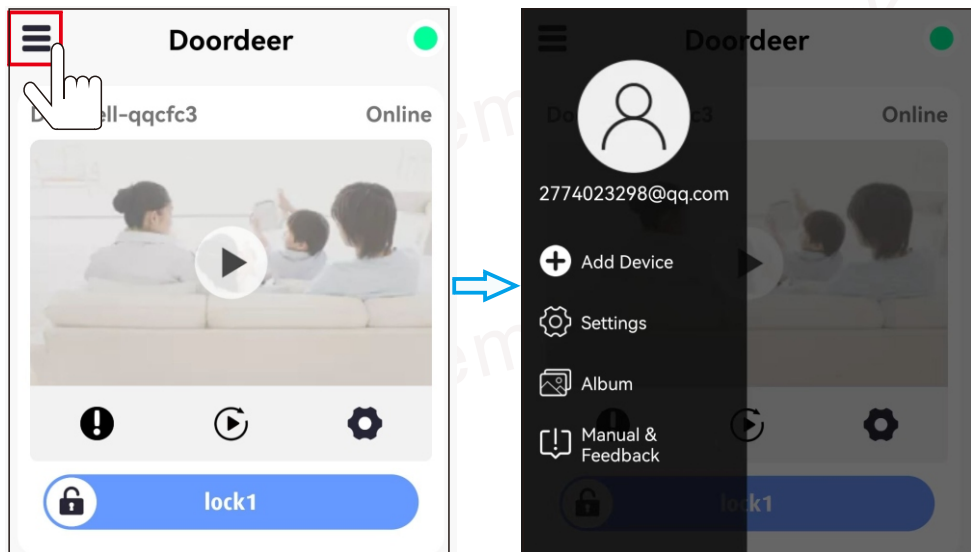



- Click ☰ on the left Column, a Setting Menu pop up and each setting is listed in below table.

+	<ul style="list-style-type: none"><li>• WiFi Device</li><li>• 4G/LTE Device</li><li>• QR Code Scan</li><li>• Lan Search</li></ul>
⚙️	<ul style="list-style-type: none"><li>• View in Full Screen</li><li>• Intercom Full Duplex (No this setting in iOS version)</li><li>• Ringtone Settings</li><li>• AP mode WiFi settings</li><li>• Clean cache</li><li>• Notification Settings (No this setting in iOS version)</li></ul>
📷	Check and save photos and videos you took
📖	Manual & Feedback

## 4. DoorDeer App

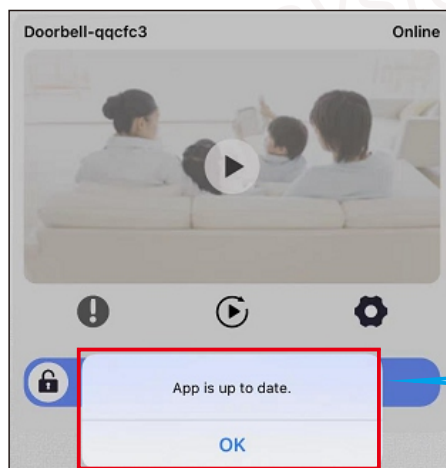
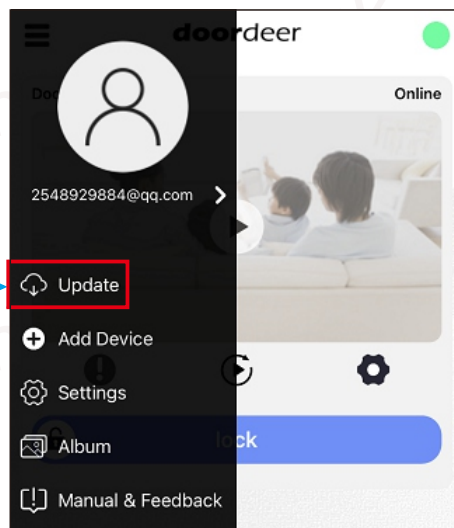
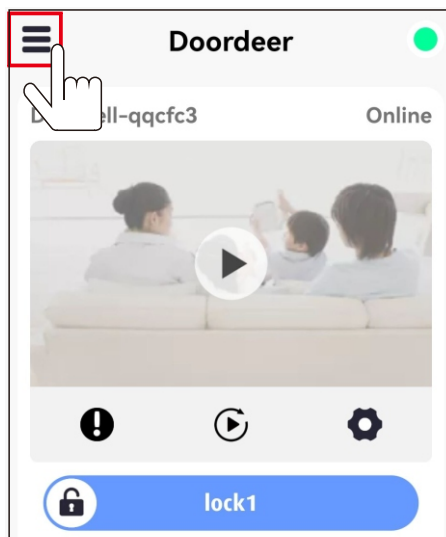
iOS Version







Click  button, the APP will automatically detect whether the existing version has been updated to the latest version, if so, it will display this prompt.

## 4. DoorDeer App

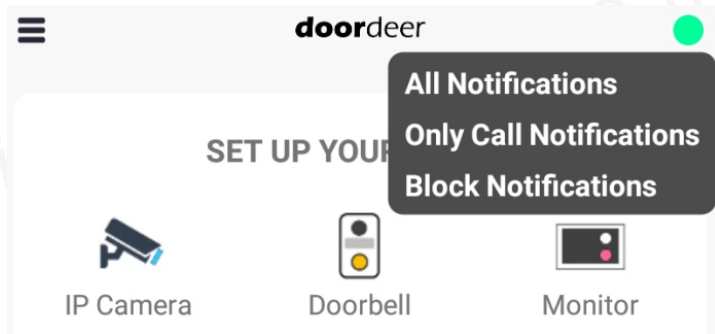
---

### 4.3 Notification Settings



-  (Green) Allow all notifications
-  (Yellow) Only Doorbell notifications,  
no motion detection notification etc.
-  (Red) Block all notifications,  
cannot receive any notifications.

## 4. DoorDeer App

### 4.4 Monitoring

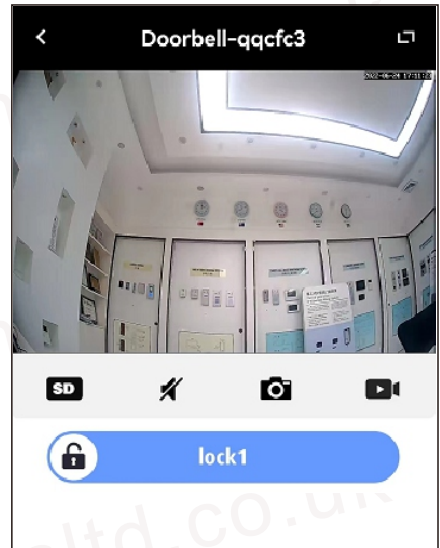
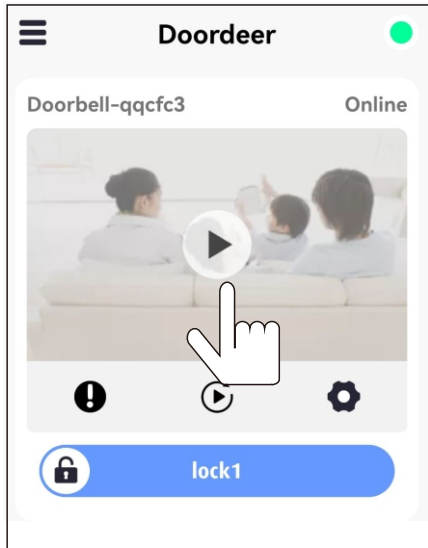

Click '▶' button to view the outdoor  
Click '🎤' button to talk  
Slide '🔒' button to unlock

## 4. DoorDeer App

### 4.5 IP Device Settings

#### 4.5.1 Master-account in Android System

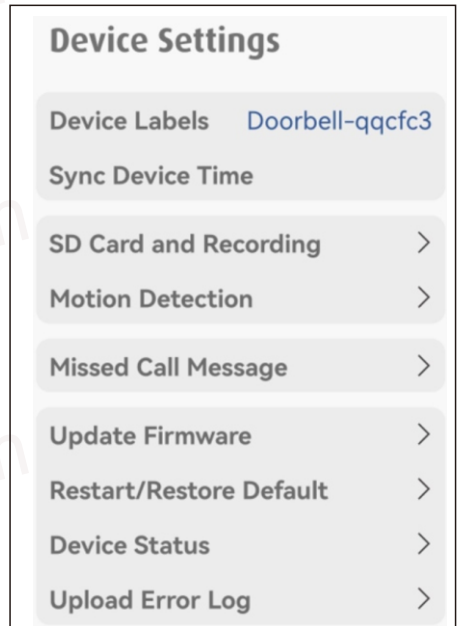
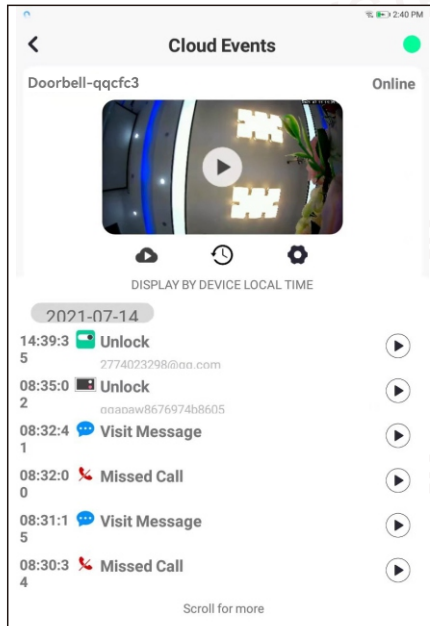
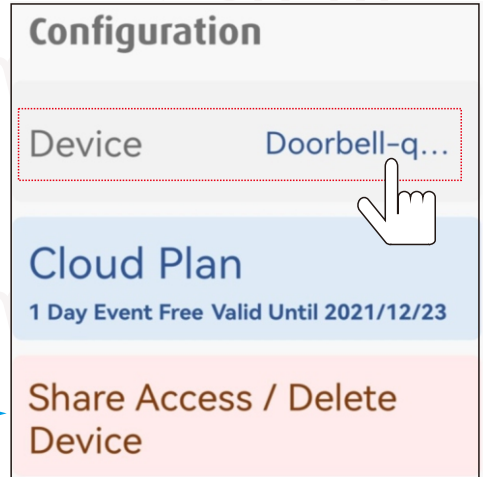
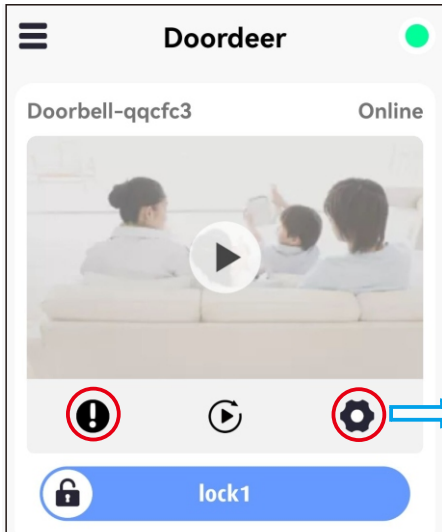

## 4. DoorDeer App

### 4.5.2 Master-account in iOS System

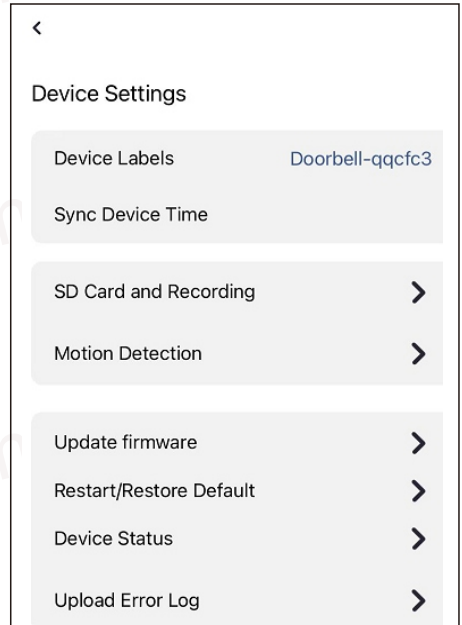
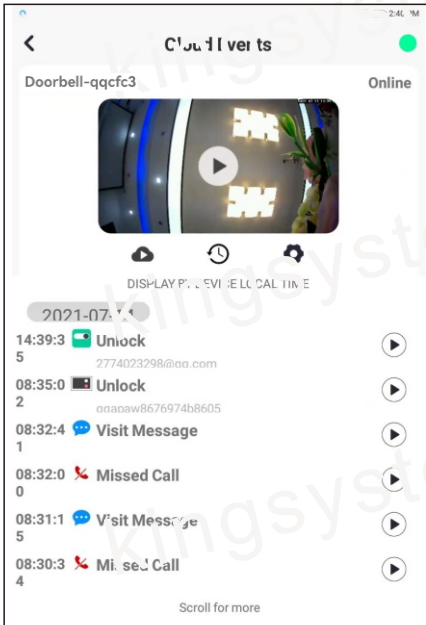
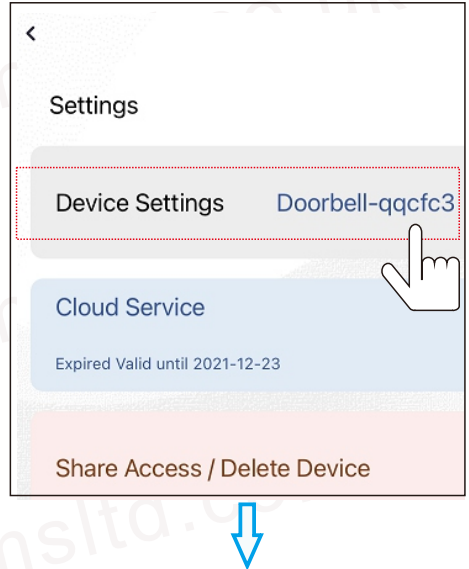
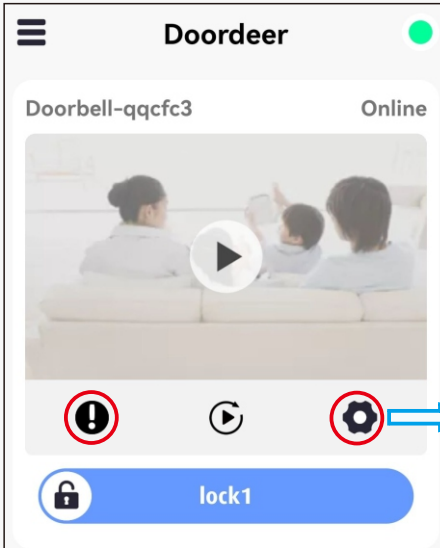

## 4. DoorDeer App

### 4.5.3 Sub-account in Android System

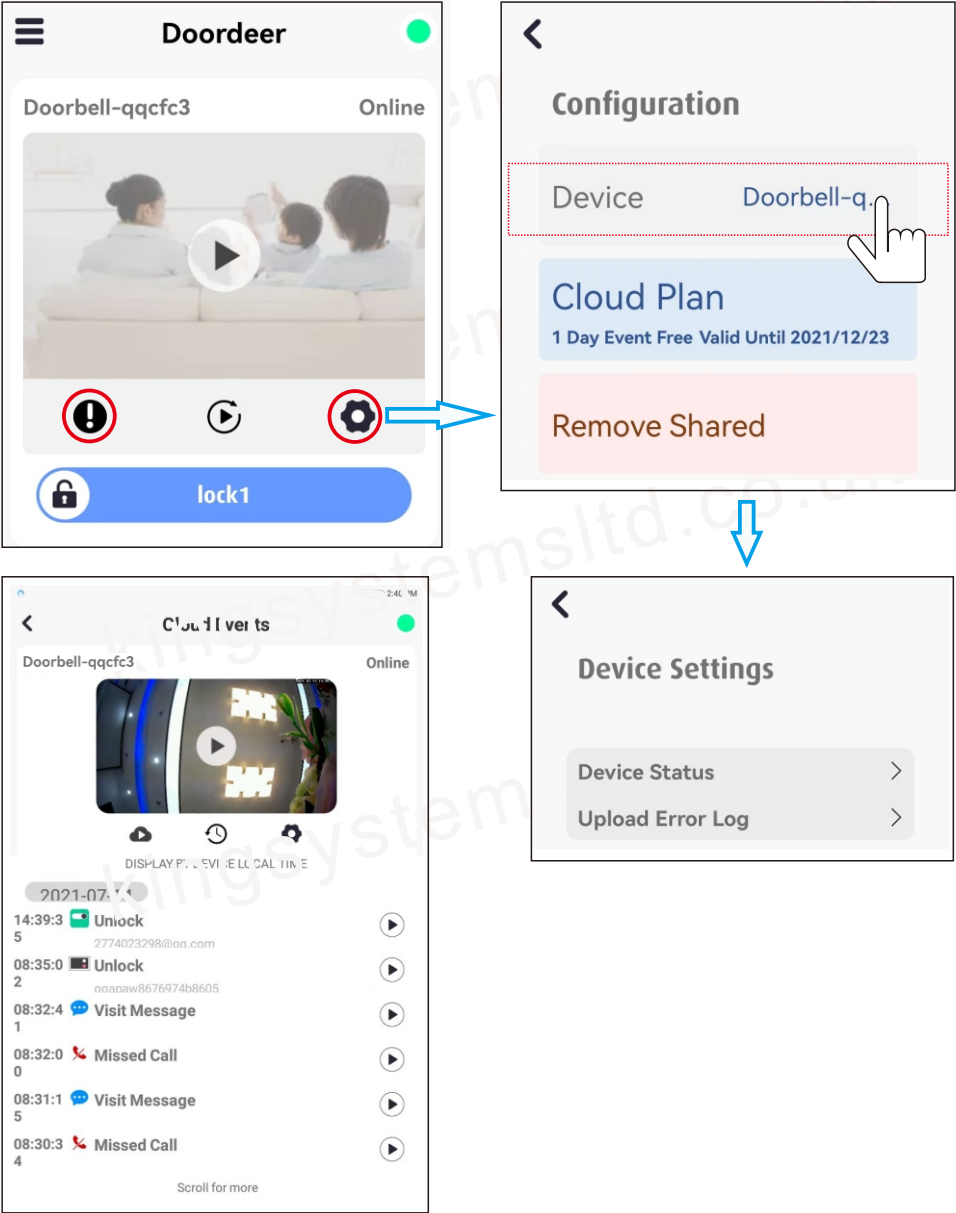

## 4. DoorDeer App



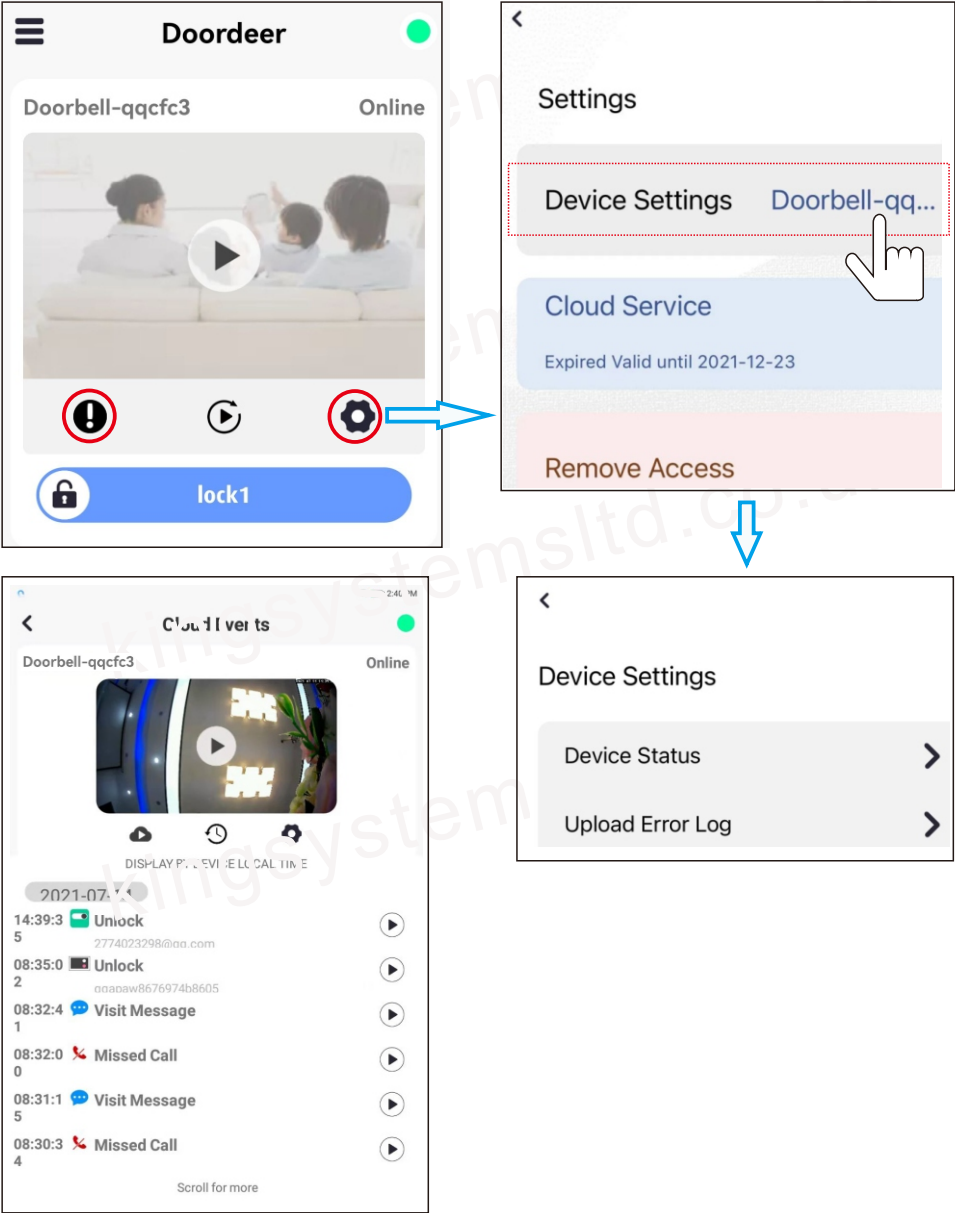







### 4.5.4 Sub-account in iOS System





## 4. DoorDeer App

### 4.6 App icon's description

Icon	Description	Icon	Description
	View live video, monitoring		Tag to Capture
	Slide to the right to unlock		Tag to take video record
	Motion detection video playback entry (if micro SD card -class 10, max.32G had inserted in device)	 	Audio On/Off on Outdoor ON / OFF
	Delete Device	 	Tap to talk(iOS); Hold to talk, release to listen(Android)
	Cloud Plan: Choose a suitable plan for your own family.		
	Share Access / Delete Device: Share a Sub-account to other people. / Remove the device from App		
	Device Labels: Rename the device.		
	Sync Device time: Sync device time with your time zone.		
	SD Card and Recording: Format your micro SD card on APP if you had inserted.		
	Motion Detection: Enable or Disable; set detection area (tap the squares to select detection area); set sensitivity (low to high).		
	Missed call Message: Leave a message to visitor.		
	Update Firmware: Do it after you have confirmed with the technician.		
	Restart / Restore Default: Restart the device. Restore default = default all settings		
	Device Status: Check device version when necessary.		
	Upload Error Log: Unload Error for problem shooting.		

## 5. Installation

---

### 5.1 Installation Diagram

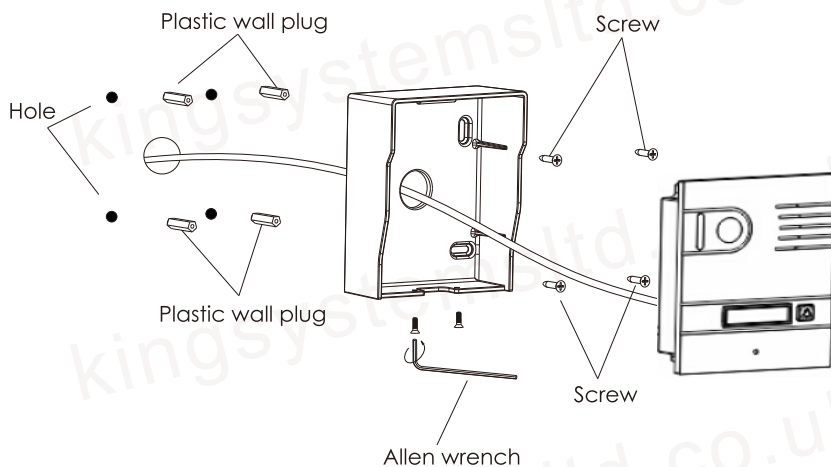

---

### 5.2 Instruction

- Do not mount the IP Outdoor until you complete APP configuration.
- When IP Outdoor is under WiFi antenna connected, make sure the distance between IP Outdoor and the Router not over 50 meters (164 fts); if one wall blocked, the distance should less than 30 meters (98 fts).
- Install the IP Outdoor where it can receive excellent WiFi signals.
- Under weak WiFi signal environment, install IP Outdoor by using Ethernet cable.

## 5. Installation

### 5.3 Notes in installation process

- **Location:**

Choose a location for IP Outdoor, taking into consideration of sightliness, shadows, and excessive back - ground lighting for the IP Outdoor. You must also consider proximity to AC power and the ability to run wiring for additional optional accessories.

Consider drilling a 1¼" diameter or larger hole into the wall behind the IP Outdoor for the concealment of the WiFi antenna (if used) within the wall.

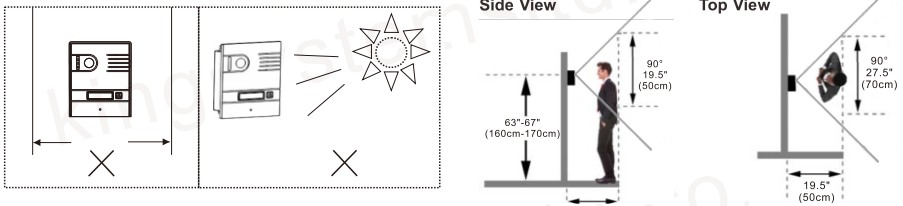

**Notes:**

1. The proper height of IP Outdoor is between 63"-67" (160-170cm) from the ground and this may vary on each installation. View range should be actively tested before completing the installation.
2. Viewing window of the camera is about 19.5" (50cm) vertically and 27.5" (70cm) horizontally.
3. Narrow space may cause echo.
4. Direct sunshine can cause blurry or ghost.

## 5. Installation

---

- **Back Box Mounting**

Feed the power supply wiring, wiring harness(s), and the WiFi Antenna cable or the RJ45 cable through the hole from the back side of the back box. Use the four screws (and anchors, if required) supplied to mount the back box to the wall in the desired location.

- **Set the desired unlock duration time & wire connection**

Using the switch(1s or 5s) on the back of the IP Outdoor, and then connect the wiring harness and other connections to the back of it. Gently feed excess wiring through the hole in the back box into the wall cavity, and place the device into the back box (top first).





**Notes:**

- \* The RJ45 jack is not wired for POE.
- \* Secure the IP Outdoor into the back box at the bottom leading edge using two supplied Hex-Head screws and Allen key.

# 6. Main Functions

## 6.1 Intercom & Monitor & Unlock the door

- Intercom & Unlock

	Visitor presses calling button on the IP Device
	User's phone will receive pop-up messages with tones, click Answer button to answer the call, or hang up button to ignore the call.
	Click or hold to speak (Android half duplex need to hold to speak).
	Hold the button and slide the button to unlock.

- Monitor from APP

Click  to view live video, monitor IP Outdoor, capture or record if you need.

## 6.2 Check history events and play back

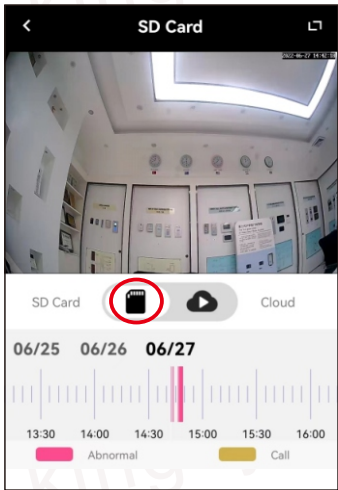

Events in SD Card

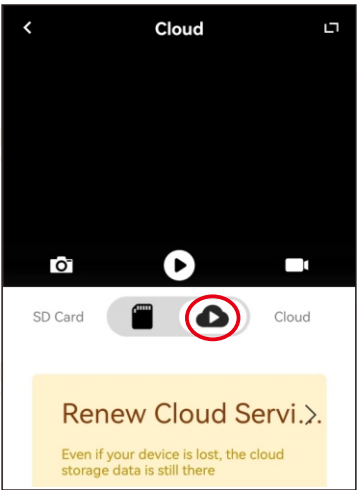

Events in Cloud

## 6. Main Functions

### 6.3 Motion Detection Settings

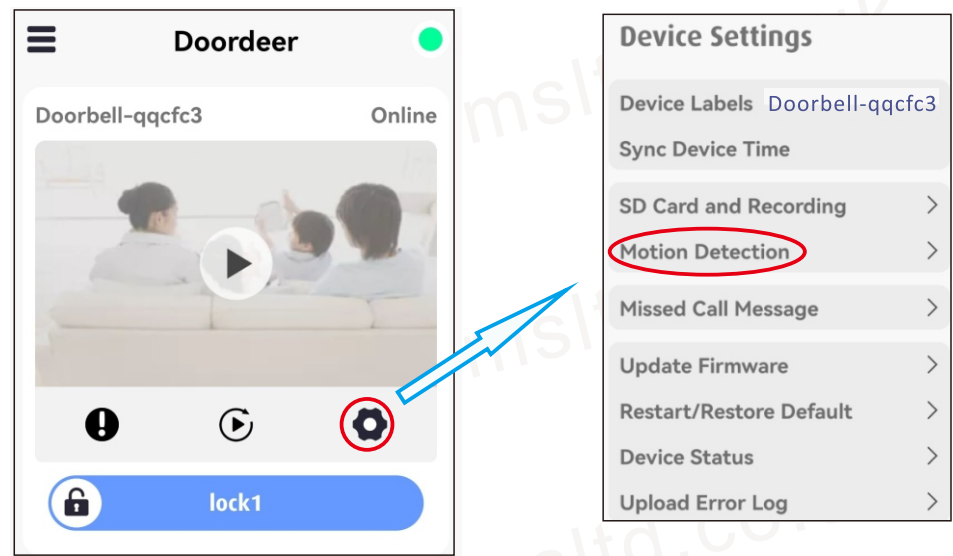

Click ⚙️ into the setting menu

Click sub-menu  
Motion Detection

6. Main Functions

<

✓

Motion Detection

Enable Motion Detection

Detection Areas

>

SENSITIVITY

low   average   sensitive   high

DETECTION SCHEDULE

00:00 - 23:59

S

M

T

W

T

F

S

✕

Add A Rule

Enable / Disable Motion Detection

Slide to set Detection Area, from low to high

Set Detection Schedule

<

✓

Add A Rule

SPECIFIC DAYS

S

M

T

W

T

F

S

SPECIFIC TIME PERIOD

00:00 - 23:59

Add Time Period

22   58

23   59

0   0

TO

22   58

23   59

0   0

Confirm

28

## 6. Main Functions

---

- Select the detection area by clicking the small squares (it will turn to blue colour) and the default area is all the areas camera reached.

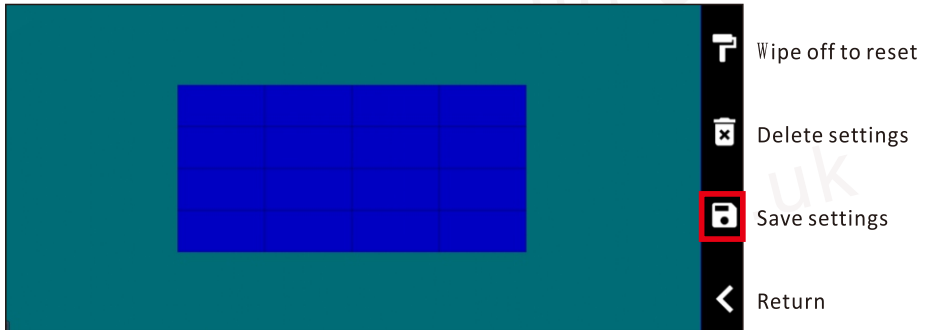

Detective Area



# 6. Main Functions

## • Trigger Motion Detection

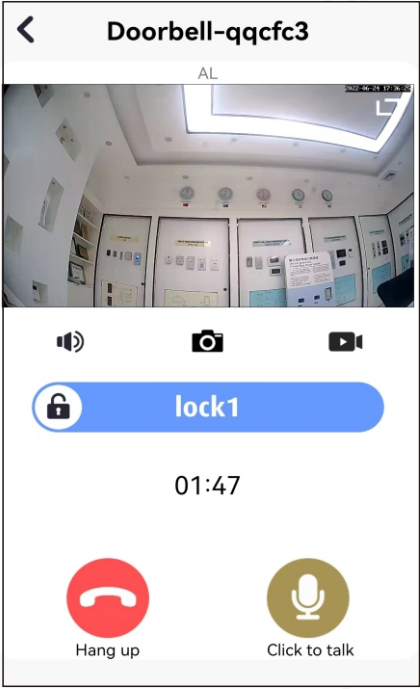

Click '📺' to view  
Click '✕' to quit

Click '🎤' to talk  
Click '📞' to quit

## 7. Q&A

---

**A. Why no push notification be seen when someone calls me ?**

Please check the network of the IP Outdoor and make sure it has connected to internet (WAN) but not just Local Area Network (LAN).

**B. What's the reason an echo caused from my Android phone when I talked with the IP Outdoor ?**

Some android phones have no AEC feature. To avoid echo please click on the half-duplex switch in the setting page (at Sidebar page– settings button).

**C. How many days will the history video be stored Cloud ?**

2 days for basic plan and 10 days for plus plan.

**D. How many smart phones can view the video at the same time ? if the IP Monitors are added, how many IP Monitors can the system supports at the same time ?**

DoorDeer App supports max. 4 monitoring device like smart phones or IP Monitors viewing the video at the same time.

**E. Why it has no any responses when I press and hold the RESET button ?**

Please make sure the IP Outdoor had completed the boot up process, need to wait 1 - 2 minutes after operate restart or re-power on. It might flash 3 times and a 'wuan' sound will be heard after boot up completed.