

IP Monitor User Manual

INSTRUCTION

IP Video Door Phone system is a full-featured IP based door entry system that allows you to monitor and interact with visitors at your door, from anywhere your mobile device has a WiFi or data connection.

Please read these instructions carefully and follow all of the required steps during setup to ensure your enjoyment of a fully functional system. You may connect the IP Monitor to your LAN (Local Area Network) either through a Wireless (WiFi) connection or a Wired (Ethernet Cable) connection, but before you connect the IP Monitor you must complete the configuration of the IP Outdoor. As connecting with any video and audio streaming device, wired connections are preferred over WiFi. But you can also install and connect devices with WiFi if it's much more stable and smooth in your environment.



Note:

1. The IP Video Door Phone System only works with 2.4GHz WiFi, ≥ 2 Mbps (upload / download speed) are suggested and is incompatible with 5GHz WiFi.
2. Before you read this IP Monitor User manual, please make sure you have added the IP Outdoor (which you'd like the IP Monitor to work with) on the APP successfully.

CONTENTS

1. Package Contents.....	1
2. IP Monitor introduction and settings	2
2.1 Product View.....	2
2.2 Product Specification.....	3
2.3 System Specification.....	3
2.4 Preparation	4
2.4.1 Standby mode	4
2.4.2 Performing factory default reset.....	4
2.4.3 WiFi Settings.....	5
2.5 Installation	6
3. APP Configuration preparation.....	7
3.1 Preparation of smartphones/tablets and network.....	7
3.2 Download App and register an account.....	8
3.3 Set the needed authorizations	10
4. DoorDeer APP.....	11
4.1 IP Monitor Configuration.....	11
4.2 IP Monitor APP Settings.....	14
4.2.1 Binding the IP Outdoor.....	15
4.2.2 Master Monitor Settings.....	15
4.2.3 Extension Monitor Settings.....	16
5. IP Monitor operation.....	17
5.1 IP Monitor interface.....	17
5.2 IP Monitor Basic Settings.....	18
5.3 Enable password and change password.....	21
5.4 Information.....	23
5.5 More Settings.....	24
6. History Event & Play back.....	25
6.1 Cloud & SD Card record playback.....	25
6.2 Check each IP Outdoor channel history events on Cloud	25
6.3 Check each IP Outdoor's detected records on SD card.....	26
7. Monitor / View Live Video.....	27
8. Main Function.....	28
8.1 Intercom, Unlock, Transfer.....	28
8.2 Internal Intercom.....	29
9. Q&A	31

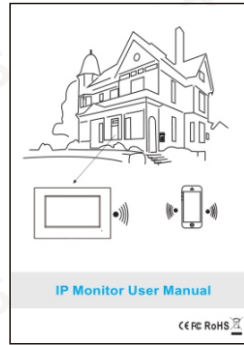

PACKAGE CONTENTS

- (1) IP Monitor
- (1) Accessories bag
(Plastic wall plug,
Screws with Anchors)
- (1) 12VDC Power Supply
- (1) Bracket
- (1) User Manual

2. IP Monitor Introduction and Settings

2.1 Product View

Front view:

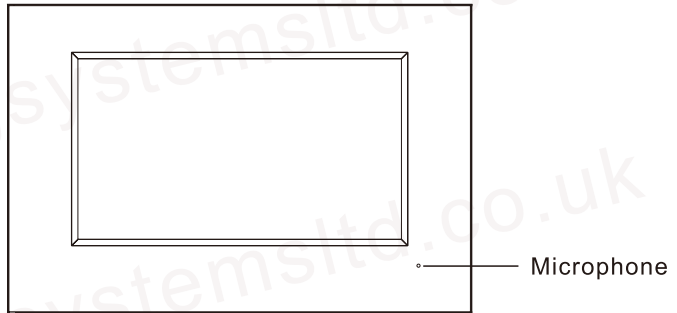

Back view:

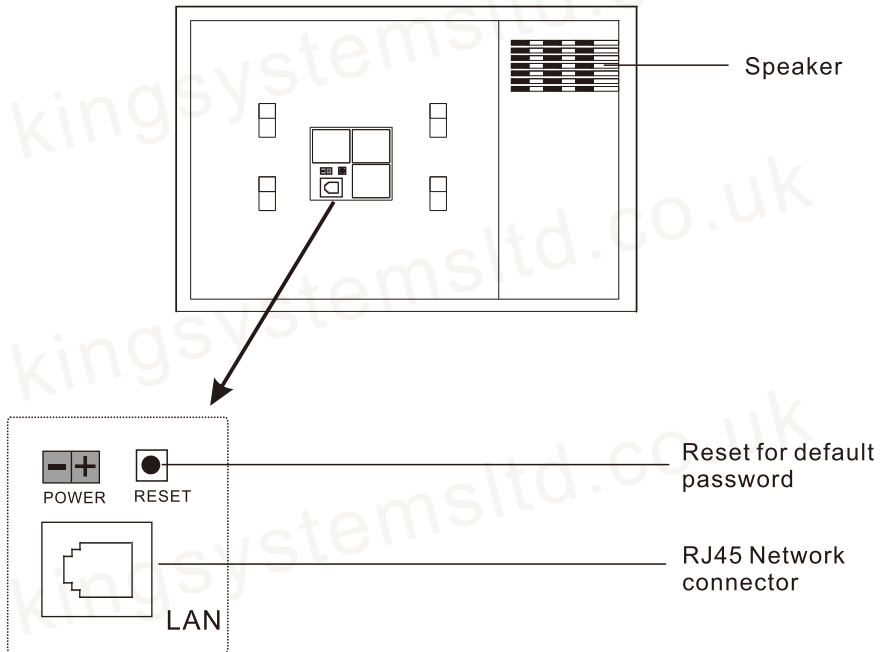

2. IP Monitor Introduction and Settings

2.2 Product Specification

Material	ABS
Color	White
Working voltage	DC 12V
Working current	100mA
Working temp.	-10℃~50℃
Solution	1024 x 600
Installation	Surface mounted
Dimension	221 x 144 x 20 mm

2.3 System Specification

Connection	Wireless / Wired
Network Connection	2.4G WiFi / Ethernet Cable
Communication duration	120s
Communication	Full Duplex
History Events Play back	Yes, APP / IP Monitor
Channels	4 x IP Outdoor / IP Cameras max. (Note: it depends on the situation of the network bandwidth)
Capacity	Max. 4 devices(App users+monitors) working simultaneously and smoothly. (Note: it depends on the situation of the network bandwidth)

2. IP Monitor Introduction and Settings

2.4 Preparation

2.4.1 Standby mode

- Supply power on IP Monitor with the adapter(12V,1A), till it displays below Interface:

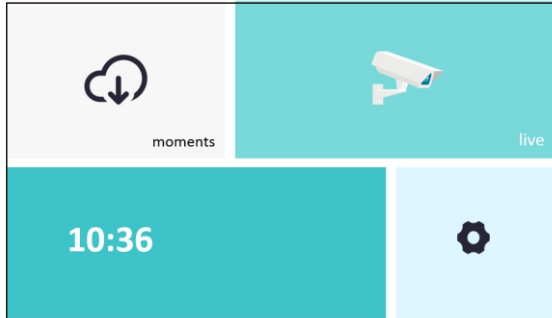

2.4.2 Performing factory default reset

- Pressing and holding 'RESET' button on the back of the IP Monitor for 10 seconds until you hear twice DiDiDi sound (NOT Di sound), then release the button.
Wait for the boot up process of the device for 1~2 minutes.

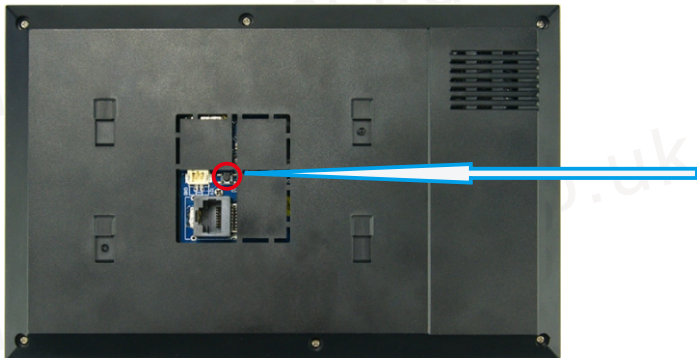

2. IP Monitor Introduction and Settings

2.4.3 WiFi Settings

- Under the standby Mode, please follow below steps to connect WiFi to it.

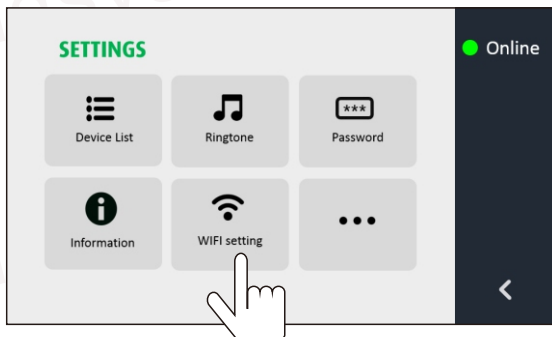
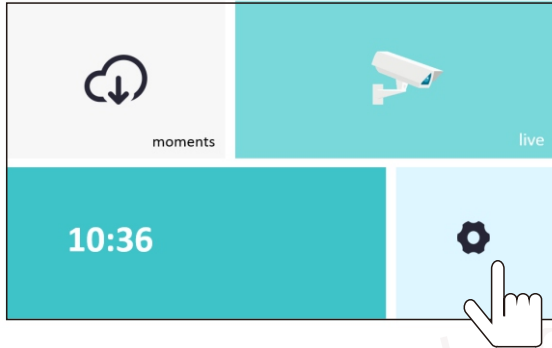

- Click 'WiFi setting', the screen will display 'Searching for WiFi network, please wait.' then display a list of WiFi accounts. To choose the local WiFi account and connect it till it shows 'Online'.

2. IP Monitor Introduction and Settings

2.5 Installation

- Do not install the IP Monitor until you finish the APP configuration.
- Install the IP Monitor where it can receive excellent WiFi network signals. Under weak WiFi signal environment, install Monitor by using Ethernet cable.

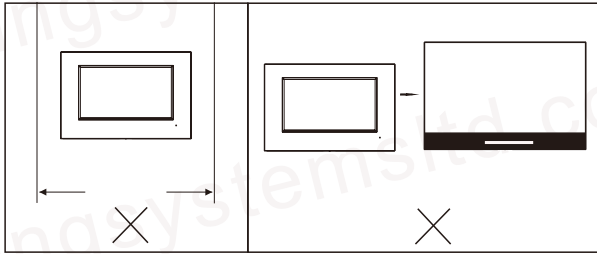

Note:

- Narrow space may cause echo.
- Installing units too close to electrical lines / dimmers / ballasts / or other electrical devices may cause audio or video interference.
- Install IP Monitor under WiFi connected (Not Ethernet wired). Support distances (from IP device to Router) listed below:
 - * Without any block obstacles, distance < 50 meters (164 fts);
 - * If the wall blocked, distance should < 30 meters (98 fts);
 - * If there are 2 walls, the support distance will be shorter.

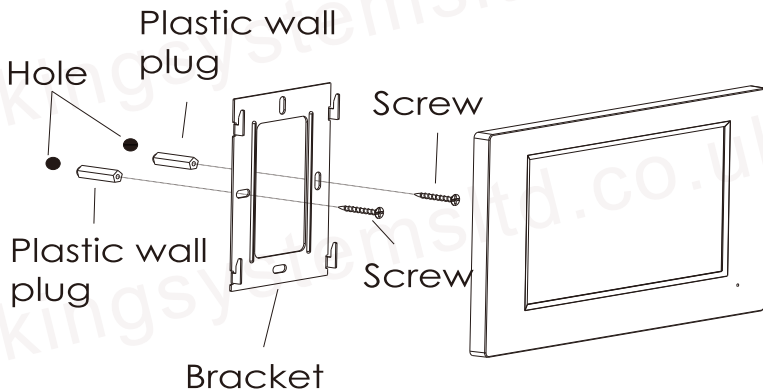

3. APP Configuration Preparation

3.1 Preparation of smartphones / tablets and network

- Make sure your device is operating with sufficient internet bandwidth, 2Mbps (upload / download speed) are suggested.
- For best performance, the smart device(s) need to be on WiFi / 4G mobile network. Actual performance will depend on the working internet environment.
- If you have limited internet bandwidth, try to avoid more than two users(including App users) operating / viewing to IP Outdoor / IP Camera simultaneously for best performance.
- For the 1st time configuration, please make sure smart phone / tablet / IP Monitor / IP Outdoor are all at the same WiFi Network.
- Turn off the Cellular / data or any running VPN services on your smart phone.
- Enable the Location (GPS) services of your phone.

3. APP Configuration Preparation

3.2 Download APP and register an account

- **Download the App**

1. Before configuration, please download the 'DoorDeer' App.
Free downloads are available on the Google Play Store (Android) and the Apple App Store (iOS)



2. Complete the installation of the App on your smart phone / tablet.
 - The DoorDeer App is free to download and use.
 - Please keep the DoorDeer App updated to the latest version.
 - The App is subject to change without notice.

3. APP Configuration Preparation

- **Setup and Log in with a New User Account**

1. Double check your smart phone is connected to the local WiFi network, which is the IP Outdoor has it connected.
2. Open the DoorDeer App.
3. Click the 'Sign up' button.
4. Choose the nearby server region.
5. Enter your email address as your account.
6. Create a new password.
7. Confirm your new password.
8. Read and click the terms and conditions to agree.
9. Press the 'Sign up' button and a pop-up message will appear, click 'ok'.
10. You'll be redirected to Login screen, please log in with your new account and password.

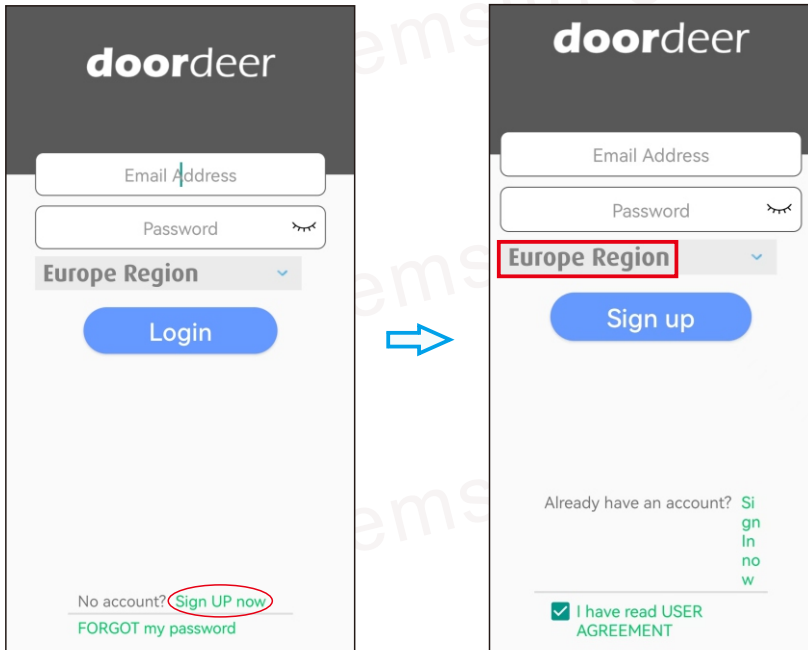

3. APP Configuration Preparation

3.3 Before configuration please set the authorizations needed:

- Notifications --- switch on 'Allow notifications'
- Location --- switch on 'Allow only while in use'
- Camera / Microphone --- switch on 'Allow only while in use'

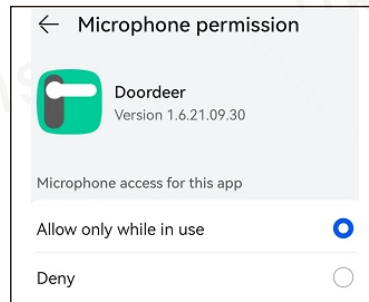
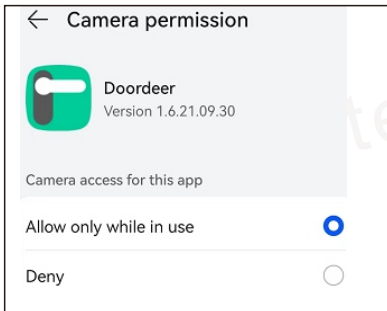
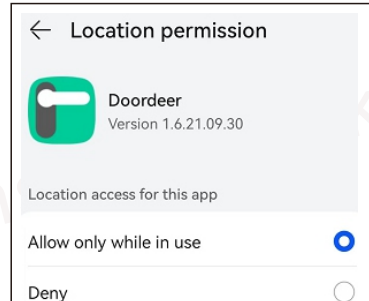
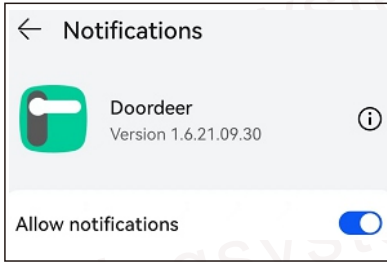

4. DoorDeer APP

4.1 IP Monitor Configuration (by LAN Search)

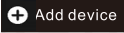
- Enter DoorDeer App, you can see the IP Outdoor you added.
(If you haven't added IP Outdoor yet, please configure it first)
- Click  on the left Column, click  to add your IP Monitor.

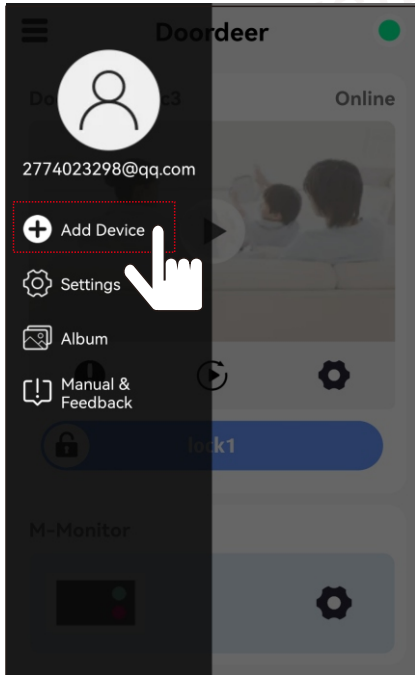

Step 1

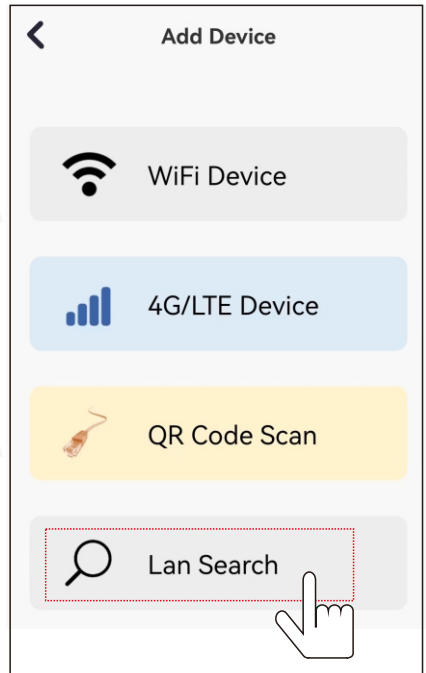

Step 2

4. DoorDeer APP

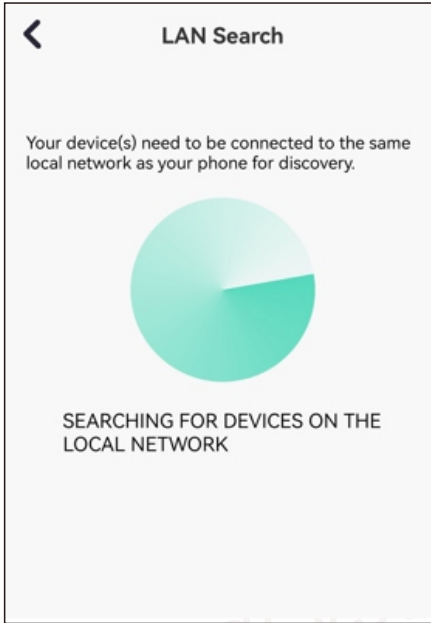

Step 3

Searching all the IP Monitors.

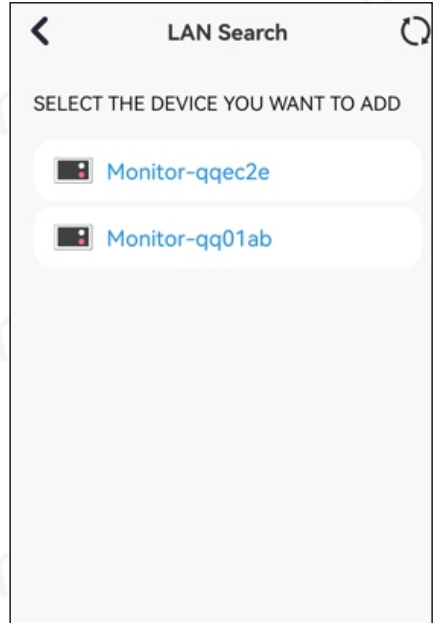

Step 4

Choose one from them as 'Master Monitor'.

4. DoorDeer APP

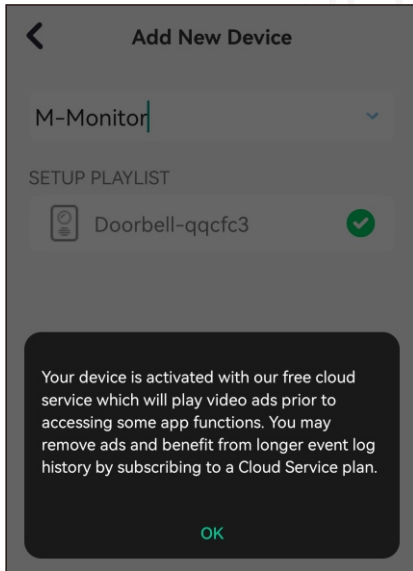
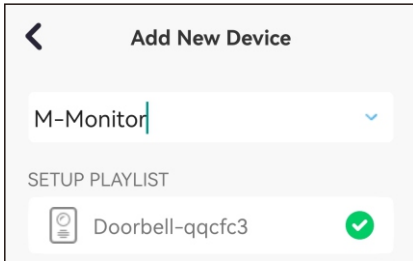

Step 5

Rename the Master Monitor and click 'OK'

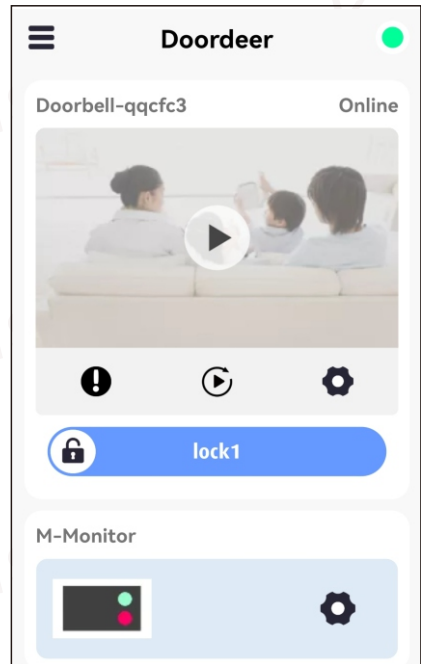

Step 6

When you see  icon is on the screen, the configuration is completed.

4. DoorDeer APP

4.2 IP Monitor APP Settings

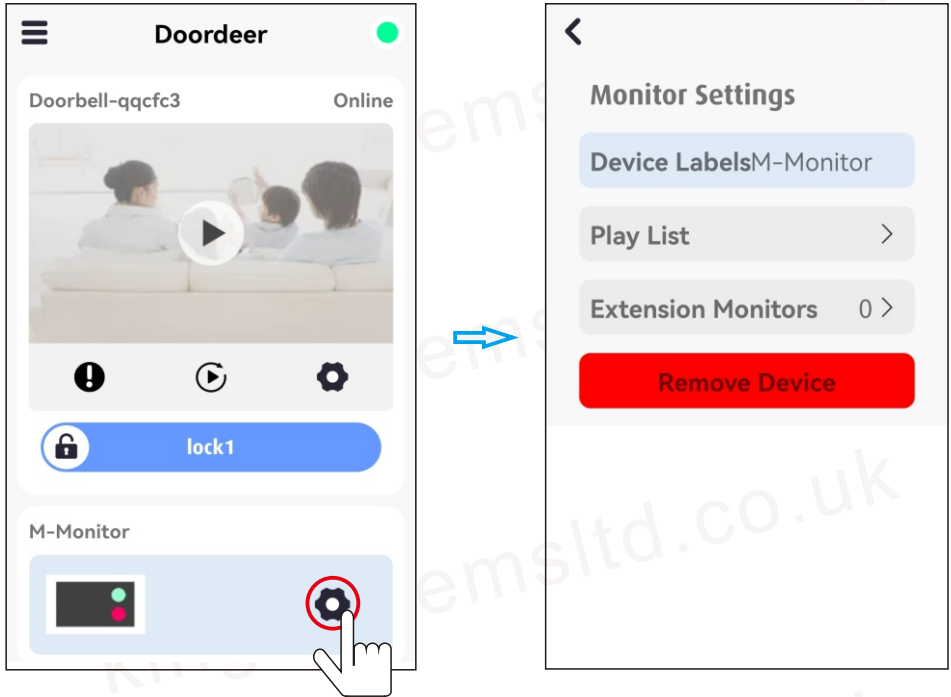

Device Labels	<ul style="list-style-type: none">• Rename the IP Monitor
Play List	<ul style="list-style-type: none">• The list of the bound IP Outdoor
Extension Monitors	<ul style="list-style-type: none">• The sub unit of the Master Monitor
Remove Device	<ul style="list-style-type: none">• Delete the IP Monitor from the App

4. DoorDeer APP

4.2.1 Binding the IP Outdoor

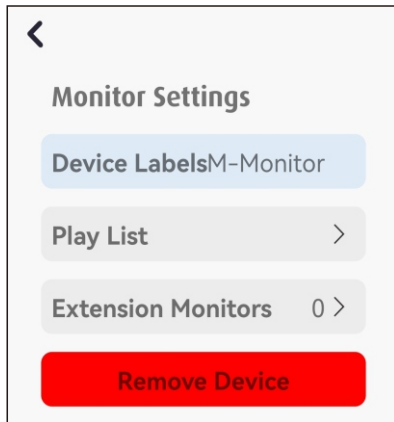

Tag 'Play List' to bind the IP Outdoor

- (1. After the IP Outdoor name, tick )
2. Tag  button to confirm)
Save

4.2.2 Master Monitor Settings

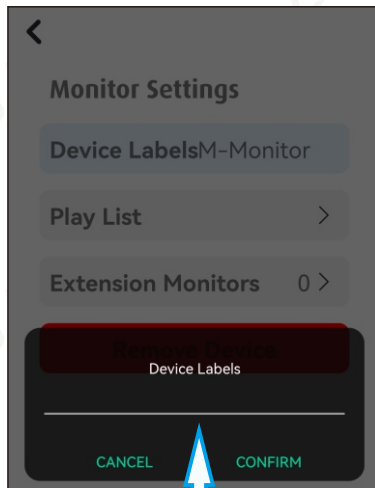

Rename the Monitor from 'Device Labels'

Note:

1. Rename the monitor from 'Device Labels'.
2. Tag 'Play List' to bind the IP Outdoor, and it will take effect in about 10 minutes.
3. If you set the monitor as the master one, no need any changes on 'Extension Monitors' (that's mean to remain as 0).

4. DoorDeer APP

4.2.3 Extension Monitor Settings

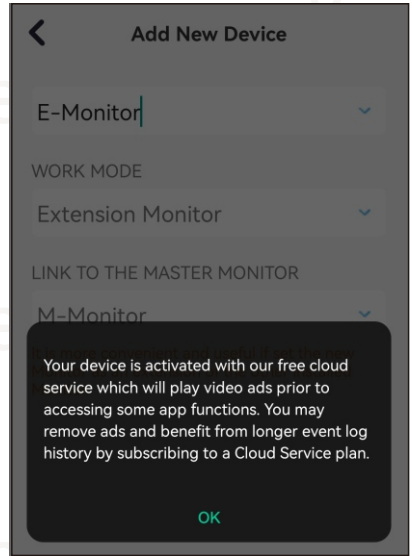
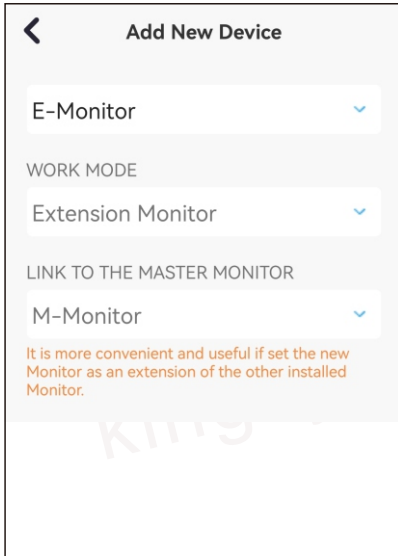





Note:

1. Under WORK MODE, please choose the 'Extension Monitor'.
2. Under LINK TO THE MASTER MONITOR, please choose the name of the Master Monitor.
3. Before you confirm the settings it will pop up a window, just click 'ok' to complete the settings.

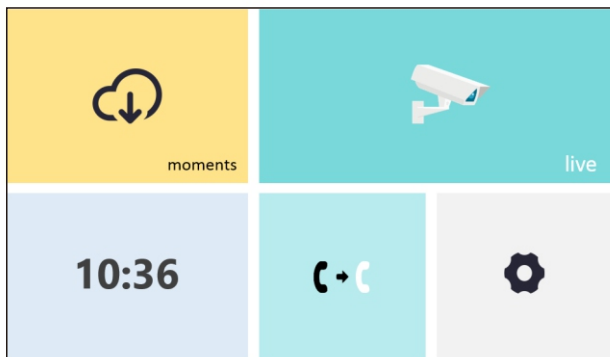
5. IP Monitor Operation

5.1 IP Monitor Interface



	Moments	History cloud record SD card record
	Live Video	View Live Video
	Settings	Device list / Ringtone / Password / Information / Screen saver / No disturb / 24 hours System
	Internal call	Tap and call the specific IP Monitor you want (When more than 2 IP Monitors are connected)

5. IP Monitor Operation





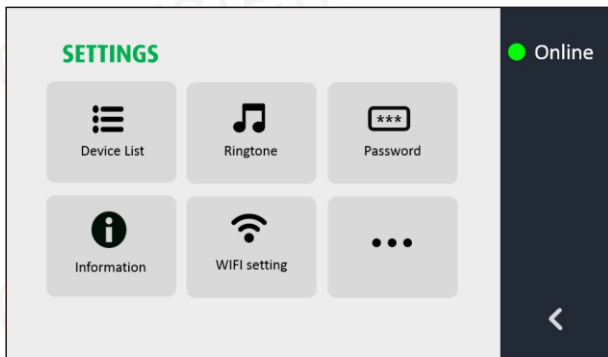
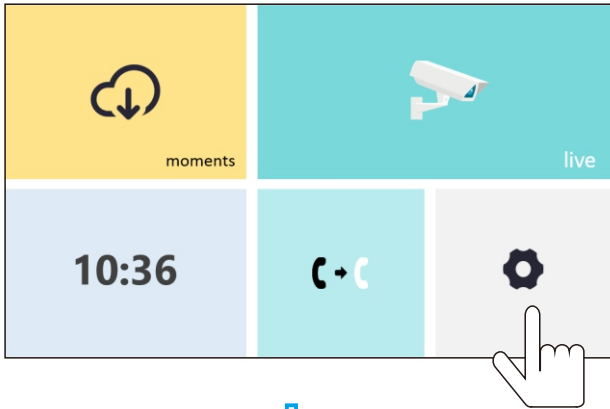



5.2 IP Monitor Basic Settings

Tap  on the IP Monitor to enter settings as below:



Basic settings' interface

5. IP Monitor Operation

 <small>Device List</small>	IP Outdoor List	Check the IP Outdoor which had bound IP Monitor
 <small>Ringtone</small>	Ringtone	Ringtone Volume settings: 0-10 level Ringtone Duration 5-30 seconds Ringtone selection: 12 tones for option
 <small>Password</small>	Password (Default: 123456)	Enable / change password for entering Enable password for history & settings If you forgot the password, please press and hold the reset button on the back of IP Monitor to restart the factory default password (123456) .
 <small>Information</small>	IP Monitor Information	Language settings Check IP Monitor's GID, IP address and version, Check new version if necessary.
 <small>WiFi Setting</small>	WiFi Setting	Tag this icon to connect local WiFi.
	More settings	 Screen-Saver ON (suggested) / OFF  No Disturb  24 / 12 hours time shift.

5. IP Monitor Operation

- Device list

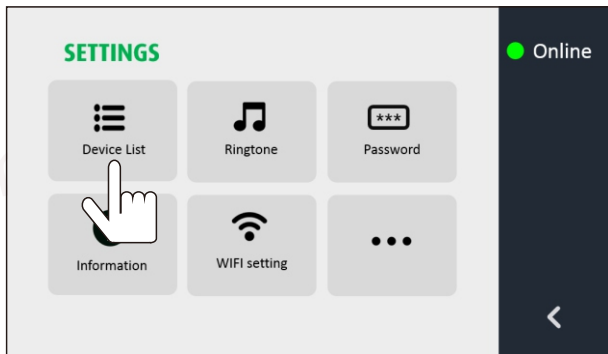

Check the IP Outdoor which had bound to the IP Monitor in here.

- Ringtone

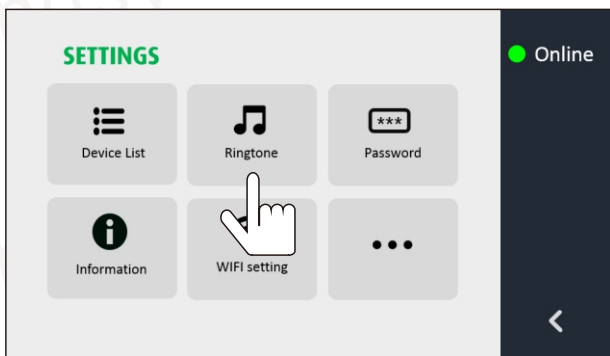

To set the Ringtone volume, duration and choose one Ringtone from the 12 options

5. IP Monitor Operation

5.3 Enable password and change password

5.3.1 Enable password

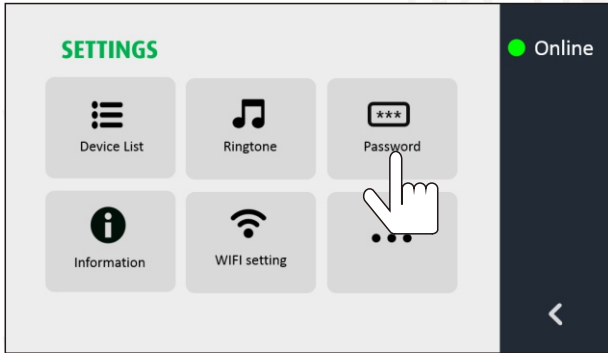

Password (default:123456)

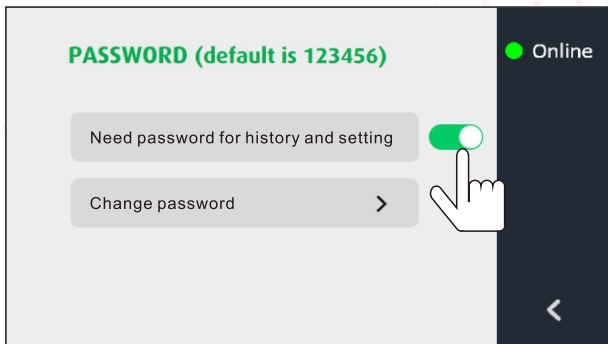



Tag  icon, slide the bar  to the right

5. IP Monitor Operation

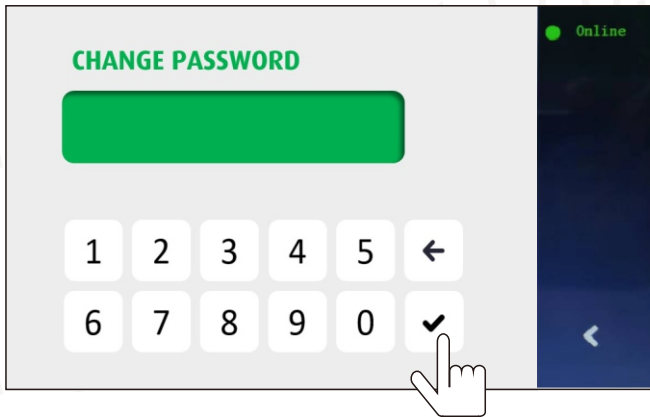
5.3.2 Change password



Tag  icon, input 6 digits new password
Tag  icon to save the password.

5. IP Monitor Operation

5.4 Information

- IP Monitor information is listed in here.

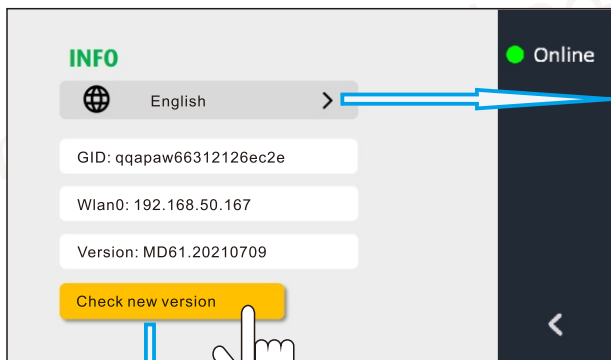
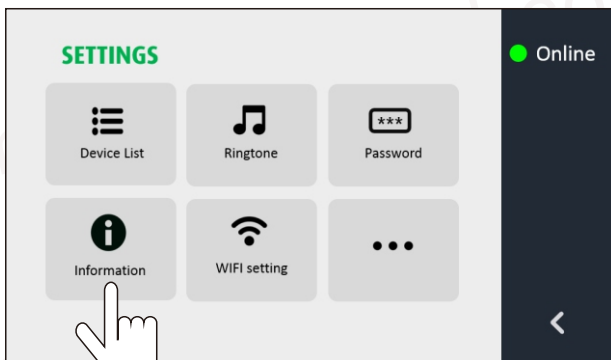





Click to choose language

GID	IP Monitor's unique ID number
IP	IP Monitor's IP address
Version	IP Monitor's firmware version
Check new Version	Do this step when it's very necessary or under technicians support.

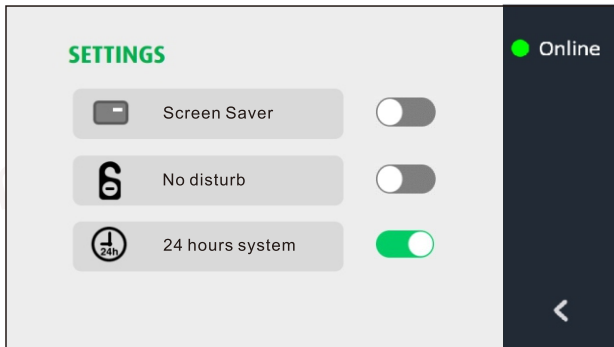
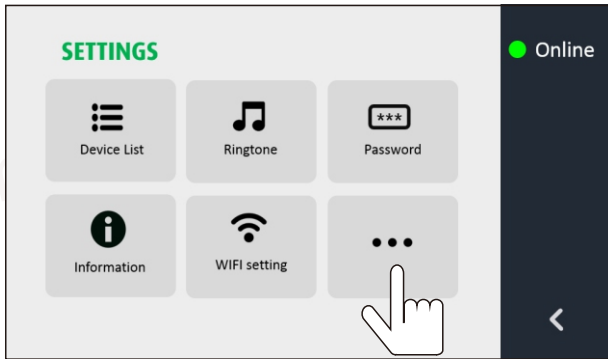
5. IP Monitor Operation

5.5 More settings



	Screen-Saver ON (suggested) / OFF
	No Disturb
	24 / 12 hours time shift

6. History Event & Play back

6.1 Cloud & SD card record playback

- Click  icon, you can playback the activities in Cloud or SD card. History events and records can also be checked and replayed on DoorDeer App.

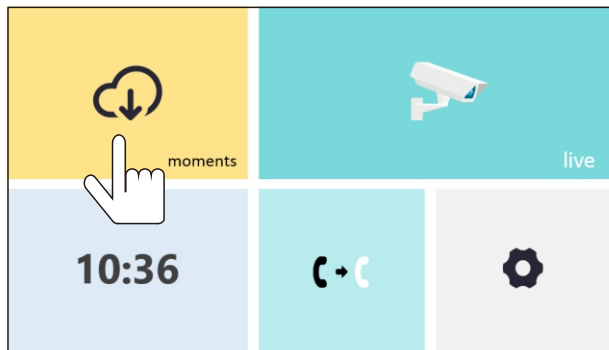

6.2 Check each IP Outdoor channel history events on Cloud

- Click  icon to check history on Cloud.
- Select specific IP Outdoor Channel in right column, take Channel 2 as examples.
- Click any record of them. display 'connecting'.
- Live videos will be played after 15 seconds.
- The files record from top to bottom are sorted with the latest and farthest date.

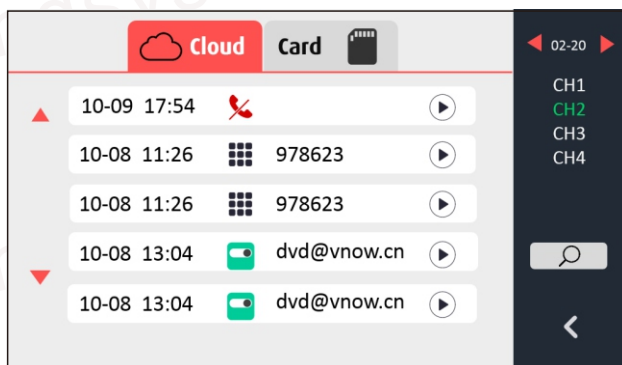

6. History Event & Play back

6.3 Check each IP Outdoor's detected records on SD card

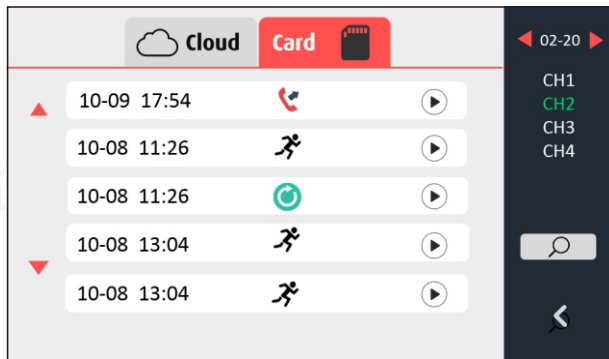

- Select the specific date, then you can check the records.
- You can play back 2-day Cloud history events for free. If you want more days events available, you need to subscribe to App.
- Events of Cloud history or Card record have difference.
- Cloud history stores all the events (unlock, monitor, motion detection, missed calls etc) of the IP device.
- Card Record only stores the motion detection videos (of everything comes into the detected area you set).

Note:

Check the card history events only when a micro SD card is inserted into the IP Outdoor and the motion detection function is enabled on APP. Same records as  on APP.

Micro SD card: Class 10, max. 32G

7. Monitor / View Live Video

- Click  icon to view live Video, monitor IP Outdoor or IP Camera, the time stamp is displayed on the upper right corner of each live video screen.

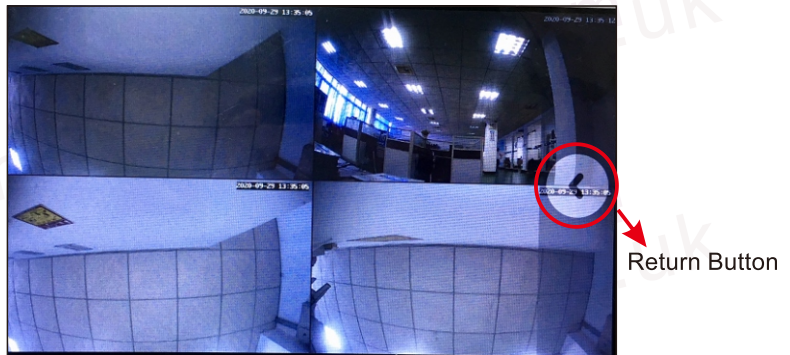
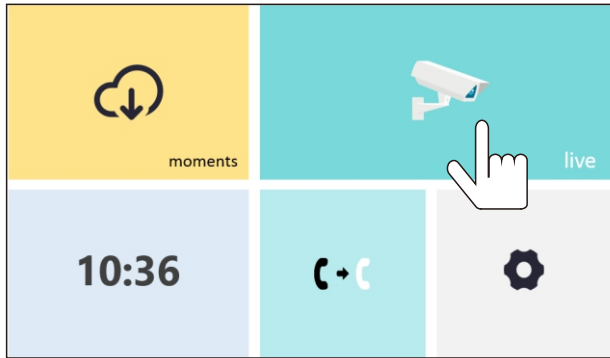



- IP Monitor supports up to 4 channels live video simultaneously. You can enlarge it by single-click the small window.

8. Main Functions

8.1 Intercom, Unlock, Transfer

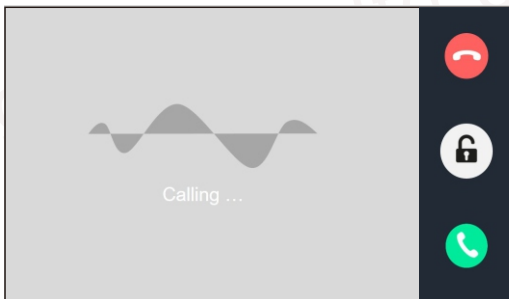
- When visitor presses the calling button on IP Outdoor, the IP Monitor will ring with video call-in notification as belows.



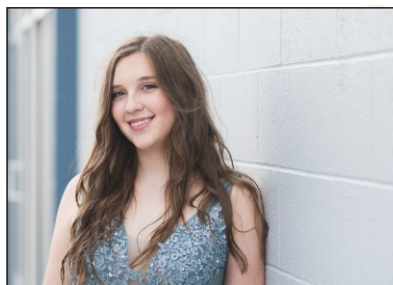

	Answer icon, click to talk with visitor, 120s duration
	Hang up icon, click to ignore the call-in notification



1xIP Monitor answering interface



≥2xIP Monitors answering interface

	Unlock icon, click to unlock the door
	Transferring icon, under answer status, click to transfer
	Mute the microphone of the IP Monitor

8. Main Functions

8.2 Internal Intercom

- When there are more than 2 IP Monitors connected in the system, internal intercom operation as belows:





- When you call other monitors, the screen of your monitor will display this connecting interface.

8. Main Functions

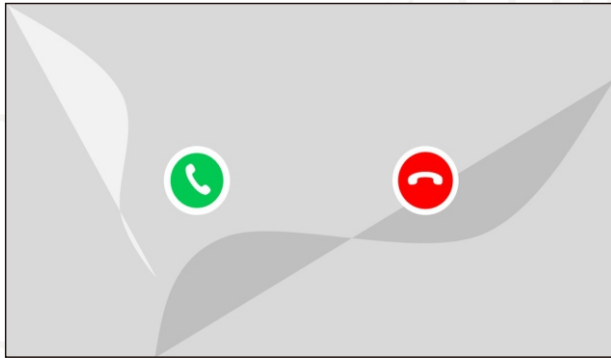
- The IP Monitor of the incoming call will display below interface:



Press  to answer the call-in
Press  to ignore the call-in

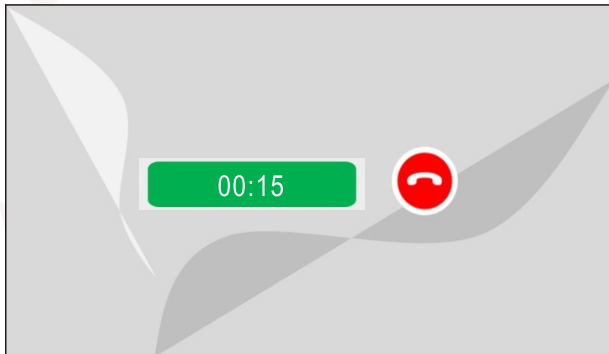

9. Q&A

A. What should I do before adding the first IP Monitor ?

You should have at least 1pc IP Outdoor / IP Camera configured in your DoorDeer App account.

B. Can IP Monitor work with LAN which does not connect to internet ?

Yes it can. When IP Monitor & IP Outdoor are in the same Local area network (LAN) they still can work. Your phone can only get the calling notification from the IP Outdoor under 3G/4G or WLAN / LAN connecting status.

C. How many days will the history video be stored in Cloud ?

The basic plan: store in Cloud 2 days

The plus plan: store in Cloud 10 days

D. What should I do after downloading the APP ?

You should register an account with an email address and choose the right Server.

E. Can the phone and the IP Monitor be picked up at the same time ?

No. When one of the users has answered the call by smart device, all IP Monitors will be hanged up automatically.

F. What would happen if a visitor call incoming during an internal conversation ?

During the internal intercom, visitor calling is in priority.